

## CONFERENCE FACILITIES / ROOM CAPACITIES

The **Athena Hall** is fully airconditioned, multi purpose room, which is divisible by sound proof manually operated partitions into three smaller rooms. This facility allows us the flexibility to change the size and shape of rooms, in order to be in a position to offer a particular room or combination of rooms to suit each specific requirements.

With the Athena Room we are able to accommodate any event from private dinner parties, to cocktail and wedding receptions, training seminars, meetings and product launches.

An alternative venue is our Syndicate room - number 4 - on the mezzanine floor, offering as well an ideal place for small meetings with a great advantage of full **natural day light**.

For a truly memorable event, Theme Nights can also be catered for, with live bands, dance groups, shows, discos and much more ....

<b>*** DIMENSIONS &amp; CAPACITIES OF CONFERENCE ROOMS ***</b>							
<b>NAME OF FUNCTION ROOM</b>	<b>Dimensions</b>	<b>Height</b>	<b>Area</b>	<b>Theatre</b>	<b>Classroom</b>	<b>Banquet</b>	<b>Reception</b>
<b>Athena Hall</b>	15.30 X 21.50	3.10 m	329 m <sup>2</sup>	400	250	270	500
<b>Syndicate 1</b>	15.30 x 14.60	3.10 m	223 m <sup>2</sup>	280	150	200	350
<b>Syndicate 2</b>	6.90 X 7.15	3.10 m	52.5m <sup>2</sup>	40	30	30	50
<b>Syndicate 3</b>	6.90 X 7.85	3.1 0 m	52.5m <sup>2</sup>	40	30	30	50
<b>Syndicate 4 (Natural Day Light)</b>	10.10 X 8.8	2.58 m	88.88m <sup>2</sup>	60	40	0	60

**\* Wi-Fi Connectivity in Conference Rooms and the Hotel's Lobby area.**

# ATHENA CONFERENCE ROOM

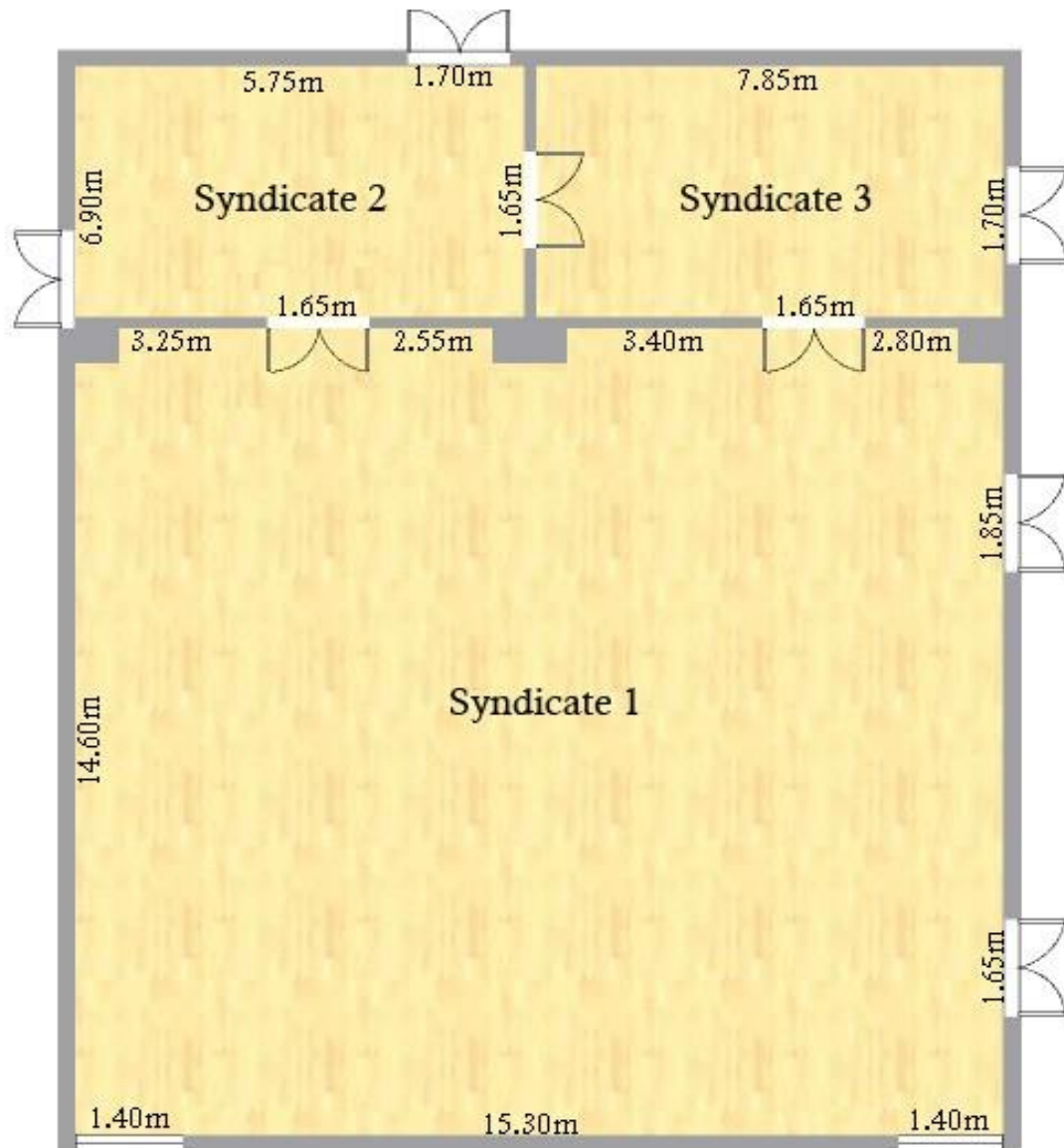

- 1: 14.60 x 15.30 m
- 2: 7.40 x 6.90 m
- 3: 7.85 x 6.90 m
- H: 3.10

**SYNDICATE 4**

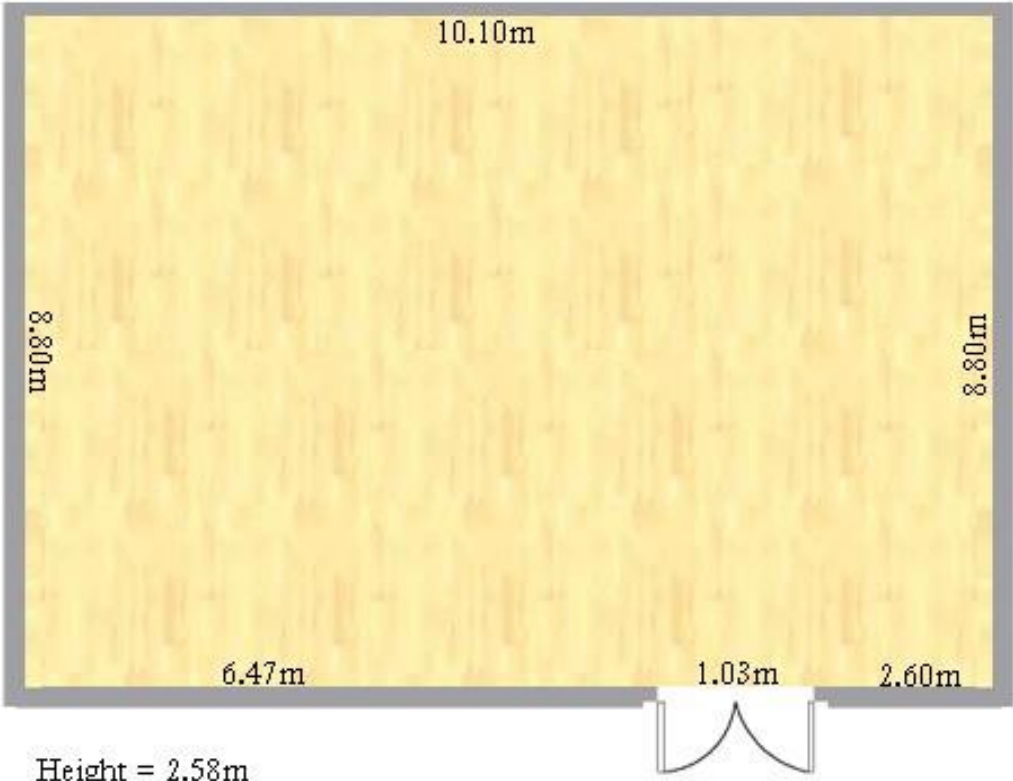

---

\* (with natural day light)